



## CYBEX/TROTTER

- Trotter 685/900T .....118
- Trotter 400/500 .....121
- **New!** Cybex ArcTrainer 600A .....124
- **New!** Cybex ArcTrainer 610A .....125

## TROTTER 685/900T



### FACEPLATE DECAL

FOR TROTTER 685

⑤ T6RDE13536



### ON/OFF SWITCH

FOR 685

⑫ T6RSW11168



### POWER CORDS

⑬ LST022, 115V

⑰ T6RWR13966, 230V



Receptacle, Inlet 20 amp

⑲ LST802

### LIMIT SWITCH KIT

⑮ T6RAM12262



**SAVE! – USE OUR REPAIR SERVICE ON THESE ITEMS!**

**DRIVE MOTOR**

- 1 T6RMR13575, New
- 1 T6RMR13575-1, Reconditioned
- 1 MRE01, Repair



**TREADMILL DECKS**

- 2 T6RE050, Exchange
- 1 T6RDK10954, Reconditioned

**OEM STYLE BELTS**

- 3 TM016



WORKS WITH 600T, 640, 645, 685, 700T, 710T, 900

**PWM BOX**

- 12 T6RAD12364, New
- 18 T6RE04, Repair

- Connectors**
- 14 T6RE01, Male
  - 15 T6RE02, Female

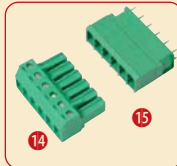

**DISPLAY ELECTRONICS**

Have us repair your display electronics for huge savings!

- 10 T6RE03, Repair



**Trotter 685/900T**

**Decks & Running Belts**

1	T6RDK10954	Deck, 685/900T, Reconditioned	\$ 200.00
2	T6RE050	Deck, 685/900T, Exchange	130.00
3	TM016	Running Belt, Factory Style	270.00

**Motors & Capacitors**

1	T6RMR13575	Drive Motor, New	1,282.75
1	T6RMR13575-1	Drive Motor, Reconditioned	425.00
1	MRE01	Drive Motor, Repair	169.00
2	T6RAM11021	Elevation Motor	648.00
3	T6RCA11213	Capacitor	100.00
4	T6REH13576	Motor Brush, 685 only	16.26
	T6RE06	Lift Motor, Repair	100.00

**Other Parts For Trotter 685**

	T6RAL10975	Roller 3", Rear	182.34
	T6RAL10980	Roller 3", Front	189.38
	T6RAX14308-1	End Cap, 685, Right	65.15
	T6RAX14308-2	End Cap, 685, Left	56.15
	T6RBD10983	Drive Belt	24.60
5	T6RDE13536	Faceplate, 685	86.68

**Deck Wax**

6	TM004	Wax Blast, 3 oz.	6.00
7	TM004.5	Wax Blast, 6 oz.	8.00

**SWITCH PANELS**

**FOR 685/900T**

- 21 T6RSW10945



**FOR 700T, 640(CR)**

- 23 T6RSK15726



**FOR 685/900T**

- 20 T6RSW13537



**FOR 710T, 645**

- 22 T6RSK15727



**Deck Wax (continued)**

8	TRHX10487	Trotter Deck Wax, 1 lb.	\$ 18.00
9	LA023	Miller Stephenson Dry Lube	16.95

**Display Electronics**

10	T6RE03	Display Electronics, Repair	140.00
----	--------	-----------------------------	--------

**PWM Box**

12	T6RAD12364	PWM, Refurbished	600.00
13	T6RE04	PWM, Repair	185.00
14	T6RE01	Male Connector	26.00
15	T6RE02	Female Connector	26.00

**Power Cords & Switches**

16	T6RAM12262	Limit Switch Kit, Left and Right	103.17
17	T6RWR13966	Power Cord, 230V (before K8)	60.00
18	LST022	Power Cord, 115V	24.95
19	LST802	Receptacle, Inlet, 20 amp	3.07
20	T6RSW13537	Switch Panel (after M09, bent tail)	76.00
21	T6RSW10945	Switch Panel (before M09, straight tail)	95.00
22	T6RSW11168	Switch, On/Off, 685 only	58.00
23	T6RSK15726	Switch Panel, 700T, 640(CR)	91.00
24	T6RSK15727	Switch Panel, 710T, 645	110.89

**IRON-ON DECK WAX**

- 8 TRHX10487, 1 lb. bag



**WAX BLAST**

- 6 TM004, 3 oz
- 7 TM004.5, 6 oz



**DRY LUBE**

- 9 LA023



**SPARE PARTS KITS**

Money-saving kits for Trotter 685/900T on page 120!

TROTTER 685/900T

SAVE 20%



SPARE PARTS KITS



FOR TROTTER 685/900T (with Bent-Tail Keyboard) T6R600

Contains:

- Running Belt (Factory Style) .....\$ 270.00
- Replacement Deck (Exchange) .....130.00
- Keypad (Bent Tail).....76.00
- Motor Brushes (2).....32.52
- Total, if purchased individually .....508.52

**Kit Price.....\$406.82**

Save \$101.70!



FOR TROTTER 685/900T (with Straight-Tail Keyboard) T6R605

Contains:

- Running Belt (Factory Style) .....\$ 270.00
- Replacement Deck (Exchange) .....130.00
- Keypad (Straight Tail).....95.00
- Motor Brushes (2).....32.52
- Total, if purchased individually .....527.52

**Kit Price.....\$422.02**

Save \$105.50!



How to Access Diagnostic Mode in the Trotter 685/900T

With treadmill in dormant mode, press 9-9-9 and ENTER on the keypad. Use the ▲ and ▼ buttons to select a specific test. Use ENTER to activate each test.

Diagnostic Menu

- |                                   |                        |  |
|-----------------------------------|------------------------|--|
| 1. Program Revision Level         | 6. DMD Cable Test      | 13. Number of Starts                   |
| 2. Dynamic Tests (see list below) | 7. RS0232 Port Check   | 14. "Out of Order" Display Mode        |
| 3. LED Test                       | 8. Clear Error Message | 15. Display Base ID and Version Number |
| 4. Tone Generator Test            | 9. Error Log           | 16. Exit Diagnostics                   |
| 5. Overlay Test                   | 10. Clear Error Log    |  |
|                                   | 11. Total Mileage      |  |
|                                   | 12. Total Hours        |  |

Dynamic Tests

To start the treadmill in Dynamic Test Mode, press the MANUAL START button. Use the ENTER button to select the test.

1. Error Register (Lists the current error code.)
2. Line Frequency Test (displays the frequency of the power source in Hz)
3. Motor Current Test (Displays the average current draw over the last 15 seconds; current draw should not exceed 8 amps with 180 lbs. load at 5 mph.)
4. Motor Voltage Test (Displays DC voltage to the drive motor; voltage should read 188 VDC at full speed.)



Great deals on Clean Wipes! See page 10.

Premium Equipment Mats

Solid rubber, comes in five sizes!

STATIONARY BIKE MAT

3' x 4' x 3/8"  
SA005, \$ 39.00

TREADMILL MAT

3' x 6' x 3/8"  
SA006, \$71.59

X-LONG TREADMILL MAT

3' x 7' x 3/8"  
SA007, \$ 76.37

AREA EQUIPMENT MAT

7'9" x 7'9" x 3/8"  
SA010, \$ 196.72

INTERLOCKING FLOORING

Call us with your area and we'll provide a quote.  
SA003, \$ 3.99/square foot

# TROTTER 400/500



## Trotter 545, 585 Diagnostic Procedures

### To enter Diagnostic Mode:

Simultaneously press the **SAVE** and **▼▲** control buttons. The message **DIAGNOSTIC TESTS ... PRESS ▼ OR ▲ TO SELECT** will appear. Press **▼** or **▲** to scroll through the diagnostics menu.

### DIAGNOSTICS MENU

C1 Program Revision Level	C7 Tone Generator Check
C2 Actual Speed	C8 Speed Sensor Count
C3 Current Draw: Current should read 3 to 5 amps without load, 10 to 13 amps with 180-pound person walking 3 mph at 0° elevation.	C9 Incline Voltage
C4 LED Test	C10 Total Mileage
C5 Overlay Test	C11 Total Hours
C6 RS232 Port Check	C12 Error Log
	C13 Number of Starts
	C14 Program Lockout
	C15 Language

## Trotter Lift Calibration

### 525, 545, 585

1. Press **ENTER** and **STOP** for five seconds. A number will appear.
2. Hold down **▼** until the treadmill stops, then raise it slightly.
3. Press **ENTER** and **▼**. This sets the lower limit.
4. Hold down **▲** until the treadmill stops, then lower it slightly.
5. Press **RESET** and **▲**. This sets the upper limit.

### 540, 575 (Serial # H11 and higher)

1. Press **CYCLE** and **RESET** for five seconds. A number will appear.
2. Hold down **▼** until the treadmill stops, then raise it slightly.
3. Press **RESET** and **▼**. This sets the lower limit.
4. Hold down **▲** until the treadmill stops, then lower it slightly.
5. Press **RESET** and **▲**. This sets the upper limit.

### 640CR, 645CR, 685, 700T, 710T, 900T

These treadmills are equipped with self-calibrating elevations and do not need to be calibrated.

**SAVE! – USE OUR REPAIR SERVICE ON THESE ITEMS!**

### DC DRIVE MOTOR 110 VOLTS

- 12 TRMR10235, New
- 13 TRMR10235.1, Reconditioned
- 11 MRE01, Repair

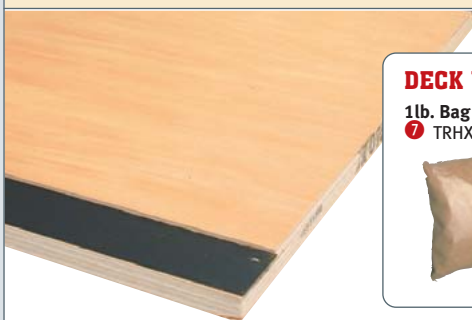

### DECK WAX

- 1lb. Bag
- 7 TRHX10487



### TREADMILL DECKS

#### FOR 575–585

- 3 TRE020, Exchange
- 1 TRDK09604, New

#### FOR 510, 535, 540, 545

- 4 TRE030, Exchange
- 2 TRDK09688, New

#### FOR 400, 410T, 510, 530

- 5 TRE03.50, Exchange

### TREADMILL BELTS

We use the same belting material as the factory!

#### FOR 400/545

- 6 TM013

#### FOR 575/585

- 7 TM015



**WE CARRY A FULL LINE OF BELTS, DECKS AND LUBRICANTS!** See page 13.

## Trotter 400/500

### Decks, Belts & Deck Wax

1	TRDK09604	Tread Deck, 53", 575–585, New	\$ 394.00
2	TRDK09688	Tread Deck, 47", New	292.00
3	TRE020	Deck, 575–585, Exchange	120.00
4	TRE030	Deck, 510, 535, 540, 545, Exchange	110.00
5	TRE03.50	Deck, 400, 410T, 510, 530, Exchange	110.00
6	TM013	Treadmill Belt, 400–545	205.00
7	TM015	Treadmill Belt, 575–585	245.00
8	TRHX10487	Trotter Deck Wax, 1 lb. Bag	18.00

### Pulleys & Bushings

9	TRHW00590	Bushing, Rear Roller	2.00
10	TRPW10134	Drive Pulley, 540–585	29.00

### Motor Options

11	MRE01	Motor, Repair	169.00
12	TRMR10235	Motor, 540–585, New	699.00
13	TRMR10235.1	Motor, 540–585, Reconditioned	361.00

### Rollers & Drive Belts

	TRAF02301	Flanged Nut, Rear Roller	8.68
14	TRAL09619	Drive Roller, 540ST–585	309.90
15	TRAL09620	Rear Roller, 540–585	225.00

### PULLEYS & BUSHINGS

#### Rear Roller Bushing

- 9 TRHW00590



#### Drive Pulley

- 10 TRPW10134



### ROLLERS

#### Drive Roller

- 14 TRAL09619

#### Rear Roller

- 15 TRAL09620



**ORDER ONLINE!**

[WWW.GYMPART.COM](http://WWW.GYMPART.COM)



## TROTTER 400/500



### How to re-wax your own treadmill decks

*Materials needed: 1 lb. of Trotter deck wax; one (1) clothes iron—never to be used again on clothing; one (1) belt sander with 120 grit sanding belt; one (1) vibrating sander with 250 grit paper and 400 grit paper.*

#### Here's how:

*Pre-existing condition: If your wood Trotter treadmill deck is worn down through the first ply, it cannot be re-waxed.*

- Using a belt sander and 120-grit belt, gently sand in the same direction as the grain the glazed layer off the top of the deck until you have reached porous wood. If, while sanding, the first layer of ply has been sanded off, the deck can no longer be re-waxed.
- Using a vibrating sander with 250-grit paper, sand the entire top surface of the deck until it is smooth and soft.
- After sanding with the 250-grit paper, continue sanding with 400-grit paper until completely smooth.
- Heat the clothes iron to its maximum temperature. Put a handful of Trotter deck wax on the center surface of the deck and place the preheated iron on top of it until the wax melts.
- Work the wax into the deck surface by pushing the melted wax across the deck with the iron. Add more wax as needed until the entire top surface of the deck is impregnated with wax.
- Apply just enough wax until the wood is saturated with wax.

**Do not leave wax pooling on the surface of the deck.**

**IS IT IN STOCK?**

FIND OUT AT [WWW.GYMPART.COM](http://WWW.GYMPART.COM)



### HANDGRIP

1 TRHX00294



### CONSOLE DECALS

2 TRDE10586



See [www.gympart.com](http://www.gympart.com) for all Trotter decals.

**SAVE! – USE OUR REPAIR SERVICE ON THESE ITEMS!**

### DISPLAY ELECTRONICS

3 TRE01, Repair

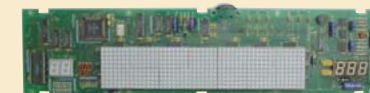

### TRANSFORMER

4 TRTR12368



### LINE FILTER

5 TREC10910



### RELAY BOX

6 TRE04, Repair



### CAPACITOR

7 TRCA10432



### CHOKE ASSEMBLY

8 TREC13810



### DRIVE MOTOR

ALL DC MACHINES

- 9 MRE01, Repair
- 10 TRMR10235.1, Reconditioned



### LIFT POTENTIOMETER

11 TRRE00465



### MOTOR BRUSH

12 TRHX10300-1



### BRUSH CAP

13 TRHX10300-2

### COMMUTATOR STONE

14 MCT035



*Tip: When replacing the motor brush, always resurface the commutator.*

## Trotter 400/500 (continued)

### Hood & Handgrips

1	TRHX00294	Handgrip	\$ 3.00
---	-----------	----------	---------

### Labels & Decals

2	TRDE10586	Decal Set, Console, 545	38.00
---	-----------	-------------------------	-------

### Electronics & Overlays

3	TRE01	Display, 540-585, Repair	119.00
4	TRTR12368	Transformer	45.50
5	TREC10910	Line Filter	36.00
6	TRE04	Relay Box, 540-585, Repair	90.00

### Motors, Capacitors, Brushes

7	TRCA10432	Capacitor, DC Machines	93.09
8	TREC13810	Choke Assembly, all DC Motors	108.00
9	MRE01	Motor, DC Machines, Repair	169.00
10	TRMR10235.1	Motor, DC, Reconditioned	361.00
11	TRRE00465	Lift Potentiometer	30.34
12	TRHX10300-1	Brush, Motor, DC Motor	8.00
13	TRHX10300-2	Brush Cap	3.50
14	MCT035	Commutator Stone	4.86

### Electrical

15	TREC00434	Speed Sensor, Pick Up, 540-585	75.00
16	TRCR10054	Gentron Module (before H-1)	69.20
17	TRAX13936	Gentron Module, (New Models)	97.00
18	TREF00285	Fuse Holder	4.00
19	TREF10042	Fuse, 25 Amp	2.50
20	TREF10043	Fuse, 3 Amp	2.00
21	TREF12367	Slow Blow Fuse	2.50

### Cables

22	TRAW09917	Cable, DDM 540 (after H12)	48.00
23	TRAW10030	Cable, Speed Sensor	14.25

### SPEED SENSOR PICK-UP

15	TREC00434
----	-----------



### SPEED SENSOR CABLE

23	TRAW10030
----	-----------



### GENTRON MODULE

16	TRCR10054, Before H-1	17	TRAX13936, New Models
----	--------------------------	----	--------------------------



### FUSE HOLDER

18	TREF00285
----	-----------

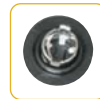

(top view)



### DDM 540 CABLE

22	TRAW09917
----	-----------



### 25 AMP FUSE

19	TREF10042
----	-----------



### 3 AMP FUSE

20	TREF10043
----	-----------



### SLOW BLOW FUSE

21	TREF12367
----	-----------



## NEW! CARDIO WORKOUT POSTERS

Available in paper for \$12.95 or laminated for \$21.95.

#### Elliptical Workout

GP600, GP600L

#### Upright Bike Workout

GP601, GP601L

#### Treadmill Workout

GP602, GP602L

#### Recumbent Bike Workout

GP603, GP603L

#### Stairclimber Workout

GP604, GP604L

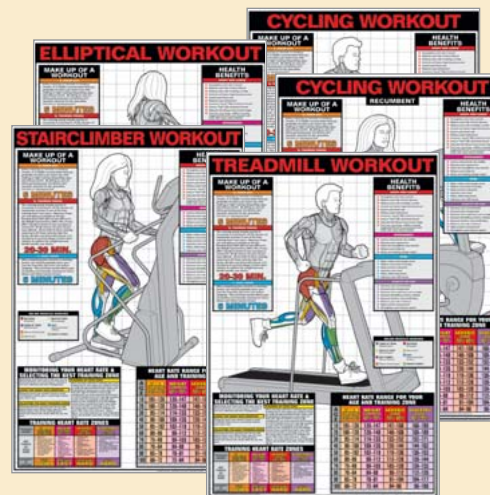

# TROTTER 400/500



## Trotter 540 Amperage Draw Test

Testing the amperage draw on your treadmill can effectively diagnose the condition of the motor, running belt, and relay box. It's a two-step process:

1. While the treadmill is running at 3 mph and at zero elevation, press both the UP SPEED and DOWN SPEED buttons simultaneously. The display should read between 3 and 5 amps. A higher reading indicates that there is a potential problem with the motor, choke, capacitor, or relay box.
2. Start walking on the treadmill. The display should read between 11 and 13 amps. A higher reading may indicate that the running belt and deck should be replaced.

## Trotter Motor OHM Test

Here's a simple way of testing the health of the drive motor of all Trotter DC models:

1. Disconnect the motor from the relay box.
2. Then, using a voltmeter in OHM test mode, check the OHM reading from the positive and negative leads going to the motor.
3. The OHM reading should be between 0.6 and 0.9. If the reading is outside this range, there is a problem with the motor and/or motor brushes.



### REPAIR HELP

See more diagnostic and replacement procedures online at [www.gympart.com](http://www.gympart.com).

## ARCTRAINER 600A



### DRIVE BELT W/ HARDWARE

- 1 CA030 (New Style)



### SECONDARY DRIVE BELT

- 2 CA027 (10-Rib, Short)



### H-SHAPE GASKETS

- 4 CA040, 14-1/2"  
5 CA043, 29-1/2"



### ELEVATION MOTOR

- 7 CA060

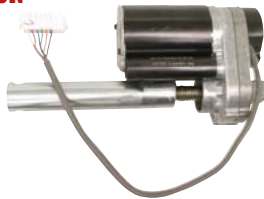

### FOOT PEDAL BALL BEARING

- 8 CA070



### PILLOW BLOCK

- 10 CA096



### WATER BOTTLE HOLDER

- 9 CA090



### CRANK ARM W/ PIN

- 6 CA218



### RADIAL BEARING

- 15 CA021



### FUSES

- 16 CA100, 2 Amp  
17 CA103, 6 Amp



### CRANK SHAFT PULLEY KIT

- 18 CA109 Crank Bearing  
19 CA086



## Arctrainer 600A

### Arms and Linkage Rod

CA200	Ball Bearing, Single-Row	\$ 5.91
-------	--------------------------	---------

### Belts

1 CA030	Drive Belt (New Style, includes Longer Screws)	71.22
2 CA027	Secondary Drive Belt, 10-Rib, Short	22.00

### Console

3 CA209	Keypad	44.20
---------	--------	-------

### Covers

4 CA040	Gasket, Rubber, H-Shape, 14-1/2"	7.82
5 CA043	Gasket, Rubber, H-Shape, 29-1/2"	15.64

### Crank Arms

6 CA218	Crank Arm w/ Pin (For Left or Right)	44.90
---------	--------------------------------------	-------

### Elevation Motor

7 CA060	Elevation Motor, 115V	213.00
---------	-----------------------	--------

### Foot Plate

8 CA070	Ball Bearing, Foot Pedal	3.69
---------	--------------------------	------

### Frame Parts

9 CA090	Water Bottle Holder	10.00
10 CA096	Pillow Block Bearing	25.29
11 CA093	Leveling Guide 3/8-16, Stainless Steel	3.25
12 CA240	Hand Rail End Cap	0.75
13 CA112	Linkage Rod Kit, Left	300.00
14 CA115	Linkage Rod Kit, Right	300.00
15 CA021	Radial Bearing	84.98

### Lower Electronics

CA252	Lower PCA	374.67
16 CA100	Fuse, 2 Amp	2.50
17 CA103	Fuse, 6 Amp	1.05

### Pulley Assembly

18 CA109	Crank Shaft Pulley Kit	180.00
CA263	Brake Assembly	484.65
19 CA086	Crank Bearing	16.24
20 CA083	Lower Shaft	24.65

### Speed Sensor

21 CA050	Speed Sensor Target Disc	5.80
----------	--------------------------	------

### LOWER SHAFT

- 20 CA083



### SPEED SENSOR TARGET DISC

- 21 CA050



# Arctrainer 610A

## Arms and Linkage Rod

1	CA001	Pivot Shaft	\$ 12.10
2	CA003	Bearing, 25mm	7.05
3	CA005	End Cap, Handle	6.05
4	CA007	Radial Bearing, 17mm	8.00
5	CA011	Bearing Spherical, 15mm	13.35
6	CA013	Internal Retaining Ring, 1.438"	0.50
7	CA015	Flange Spacer for Link Rod Cap	21.90
8	CA018	Internal Retaining Ring	0.45
9	CA021	Radial Bearing	84.98
	CA112	Linkage Rod w/ Hardware, Left (shown p.118)	300.00
	CA115	Linkage Rod w/ Hardware, Right (shown p.118)	300.00

## Covers

	CA040	Rubber H-Shaped Gasket, 14.5" (shown p.118)	7.82
	CA043	Rubber H-Shaped Gasket, 29.5" (shown p.118)	15.64

## Elevation Motor

10	CA060	Elevation Motor, 115V	213.00
----	-------	-----------------------	--------

## Drive Assembly and Belts

	CA027	Secondary Drive Belt, 10 Rib (shown p.118)	22.00
	CA030	Primary Drive Belt (shown p.118)	71.22
	CA080	Crank Replacement Kit	180.00
	CA083	Lower Drive Shaft (shown p.118)	24.65
	CA086	Crank Bearing (shown p.118)	16.24
11	CA089	Crescent Retaining Ring	0.50

## Frame Assembly

	CA070	Foot Pedal Ball Bearing (shown p.118)	3.69
	CA090	Water Bottle Holder (shown p.118)	10.00
12	CA093	Leveling Glide, Stainless	3.25
	CA096	Pillow Block Bearing (shown p.118)	25.29
	CA050	Speed Sensor Decal (shown p.118)	5.80

## Lower Electronics

13	CA100	Fuse 2 Amp	2.50
14	CA103	Fuse 6 Amp	1.05
15	CA106	Optical Speed Sensor Cable	50.00

## Pulley Assembly

16	CA109	Crank Shaft Pulley w/ Hardware	180.00
17	CA118	Lower Pulley Assembly	100.00
18	CA121	Handle Bar w/ HR grips, Left	256.75
19	CA124	Handle Bar w/ HR grips, Right	256.75
	CA127	Crank Arm Kit w/ Pin	38.26

# ARCTRAINER 610A

## PIVOT SHAFT

1 CA001



## BEARING

2 CA003, 25mm



## RADIAL BEARING

4 CA007, 17mm



## SPHERICAL BEARING

5 CA011, 15mm



## INTERNAL RETAINING RING, 1.438"

6 CA013



## FLANGE SPACER

7 CA015



## INTERNAL RETAINING RING

8 CA018



## RADIAL BEARING

9 CA021



## CRESCENT RETAINING RING

11 CA089



## FUSES

13 CA100, 2 Amp  
14 CA103, 6 Amp



## LOWER PULLEY ASSEMBLY

17 CA118



## ELEVATION MOTOR

10 CA060

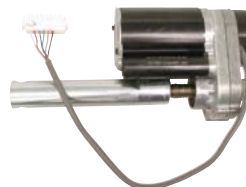

## OPTICAL SPEED SENSOR CABLE

15 CA106



## HAND RAIL W/ HEART RATE GRIPS

18 CA121, Left  
19 CA124, Right

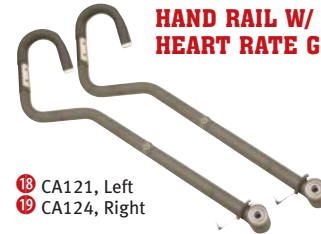

## CRANK SHAFT PULLEY KIT

16 CA109



HAND RAIL  
END CAP 3 CA005



LEVELING GUIDE

12 CA093



## CONCEPT II

- Model B Rower .....126
- Model C Rower .....127

## MODEL B ROWER

**SAVE! – USE OUR REPAIR SERVICE ON THESE ITEMS!**

### TRAVELING PULLEY ASSEMBLY

9 CON23



### Pulley, Model B

10 CON82



### DISPLAY

- 11 CON1757, New
- 12 CONE01, Repair



### SHOCK CORD

4 CON17



### SKEWER SCREW KIT

7 CON215



### BRIDGE PIN

15 CON76



### CHAIN & CHAIN SLIDE

5 CON185  
6 CON280



### FLYWHEEL COG TOOL SET

8 CON484



### FLEX FOOT

1 CON1004



### Rubber Foot

2 CON119



### SEAT ROLLER WITH HARDWARE

3 CON378



## Concept II Model B Rower

### Concept II Parts

1	CON1004	Flex Foot	\$ 8.60
2	CON119	Rubber Foot, all Models	2.90
3	CON378	Seat Roller, w/ Hardware, Model B	17.50
4	CON17	Shock Cord, Model B	9.80
5	CON185	Chain Slide, Model A, B	3.10
6	CON280	Chain, Model B	32.00
7	CON215	Skewer Screw Kit	0.60
8	CON484	Flywheel Cog Tool Set	20.00
9	CON23	Travelling Pulley Assembly, Model B	28.27
10	CON82	Pulley, Model B	11.30
11	CON1757	Display, Concept II, New	185.00
12	CONE01	Display, Concept II, Repair	40.00
13	CON76	Bridge Pin	0.50
	SC00946	Battery, 4 required (not shown)	3.50

## Concept II Model C Rower

### Mainframe Assembly

14	CON1897	Display	\$ 229.57
1	CON1703	Seat Top with Screws	18.00
2	CON1724	Seat Roller, Top	16.12
3	CON1725	Seat Roller, Bottom	5.60
4	CON119	Molded Foot Cap, Each	2.90
5	CON1720	Flex Foot Toe Piece and Screws, Each	6.00
6	CON1004	Flex Foot, Each	8.60
7	CON1501	Foot Strap, Each	4.70
8	CON1731	Shock Cord	8.80
9	CON1024	Chain Idler Pulley	2.25
10	CON1754	Handle Hook Assembly	2.63
11	CON1011	Shock Cord Pulley	3.30
12	CON1748	Monitor Pickup w/ Screw	15.95
13	CON1716	Chain w/ Connector and Swivel	28.50
14	CON244	Handle U-Bolt	1.67
15	CON279	Foam Handle Grip for Wood Handle	16.80
16	CON240	Handle U-Bolt Nut	0.30
17	CON1308	Castor Wheel Replacement, Each	1.35
	CON296	Chain Oil	6.79



**IS IT IN STOCK?**  
Find out at [www.gympart.com](http://www.gympart.com)

## MODEL C ROWER



### MAINFRAME ASSEMBLY

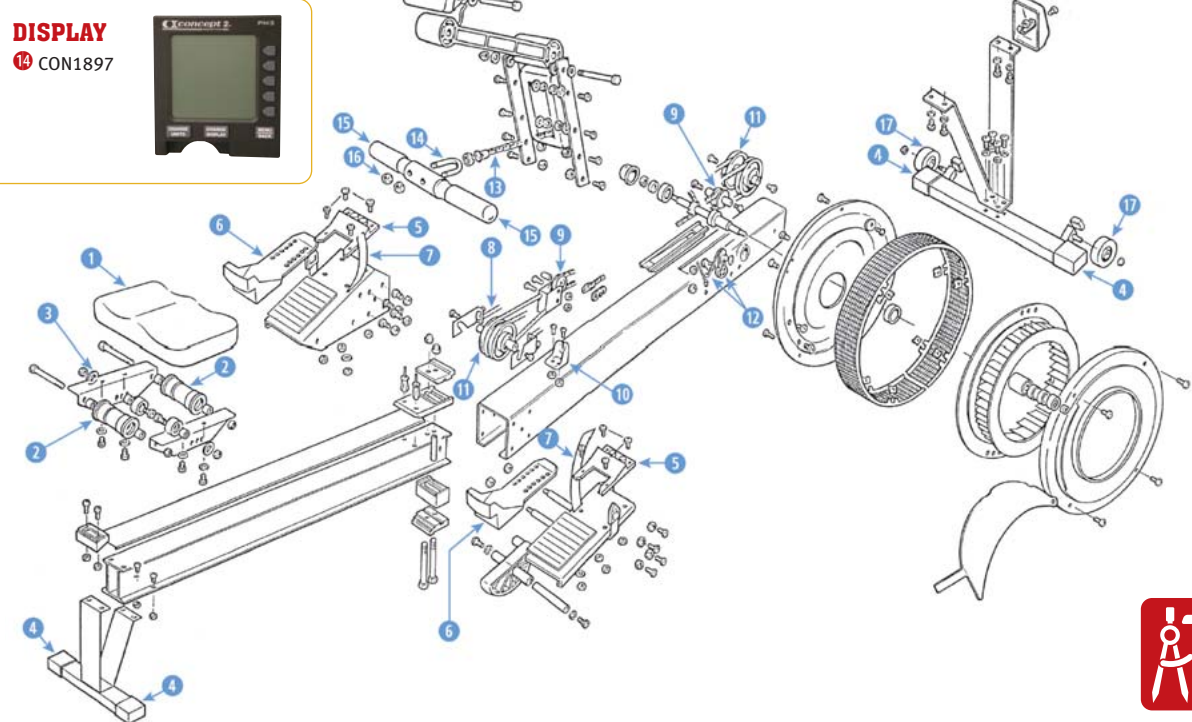

## WEARLINK TRANSMITTER

Feel the Wearlink difference. So comfortable, you'll forget it's even on. See page 162.

