

# Vectra On-Line® 1650 Cable Diagram

**Note:** The pulleys on this diagram are numbered to make the installation of new cables as easy as possible. Simply start threading the cables through the pulleys beginning with the lowest number and working up. For example, If you are installing an entire set of cables, start at pulley #1. If you are installing only a new ab/leg cable (PN 52750), you would begin at pulley #20.

**Note:** Where applicable, text and other drawings in this manual that mention or show pulleys contain corresponding numbers.

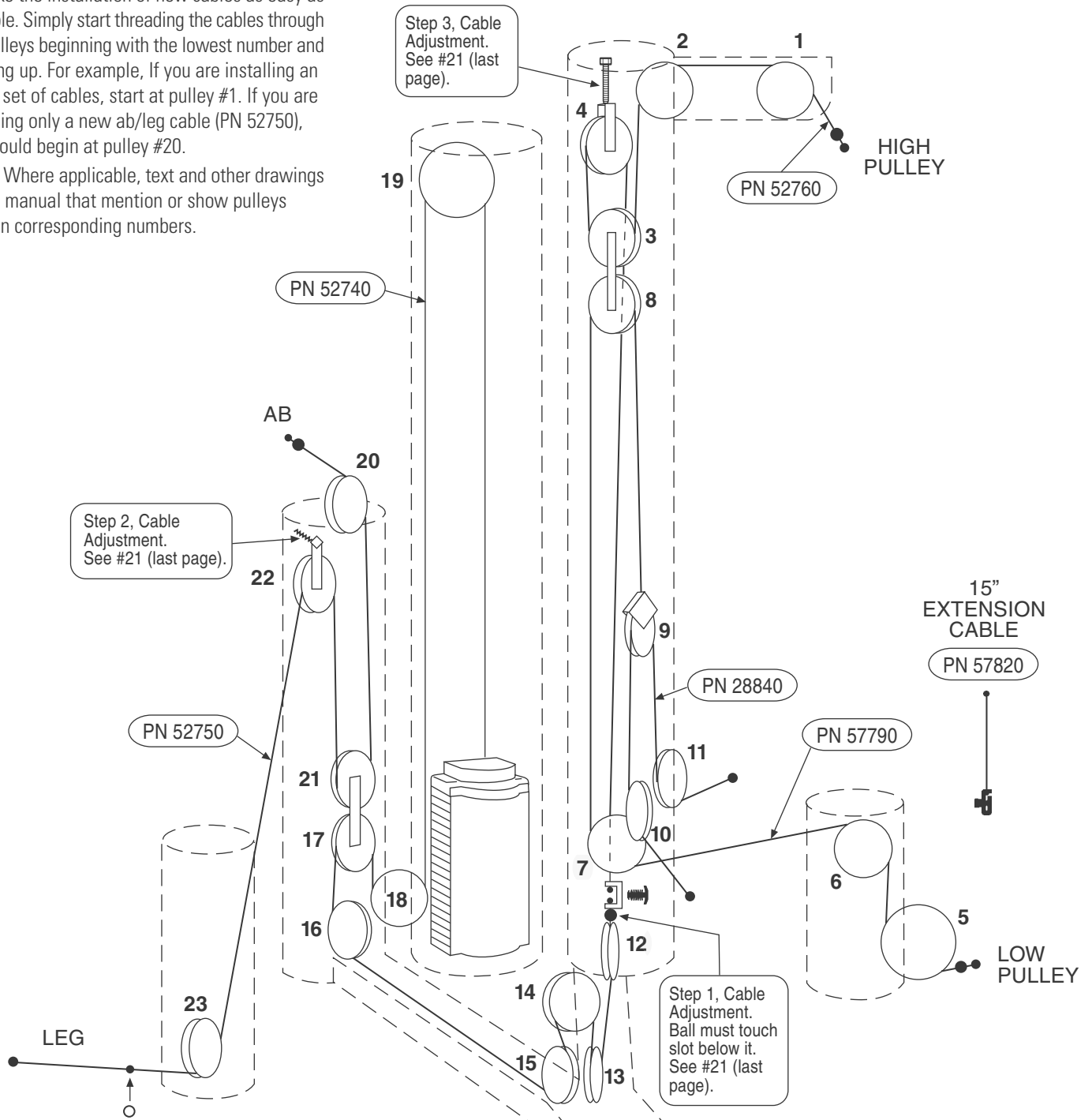

**Note:** Leg/Calf Press option cable is PN 61000.

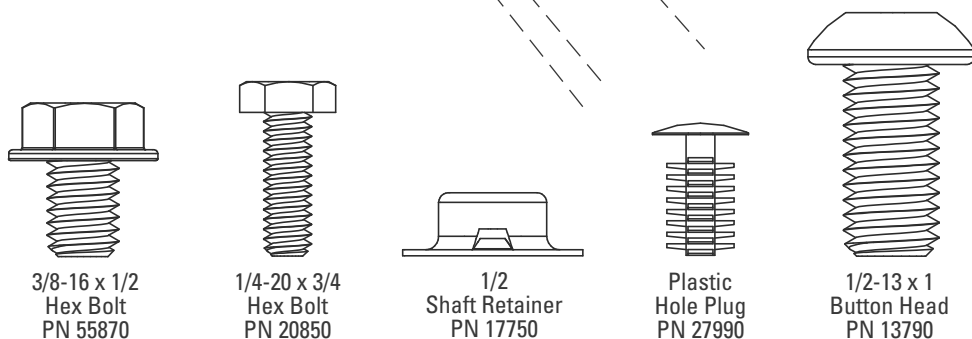

3/8-16 x 1/2  
Hex Bolt  
PN 55870

1/4-20 x 3/4  
Hex Bolt  
PN 20850

1/2  
Shaft Retainer  
PN 17750

Plastic  
Hole Plug  
PN 27990

1/2-13 x 1  
Button Head  
PN 13790